

POINT #	ELEVATION	LATITUDE	LONGITUDE
1	4452	N041°48'52.89"	W111°51'05.87"
2	4452	N041°47'01.46"	W111°51'11.87"
3	4447	N041°47'32.73"	W111°51'13.46"
4	4447	N041°47'33.72"	W111°51'12.98"
5	4447	N041°47'18.15"	W111°51'00.67"
6	4454	N041°48'21.50"	W111°50'57.30"
7	4454	N041°48'21.46"	W111°50'56.07"
8	4452	N041°48'52.87"	W111°51'01.87"
9	4440	N041°47'33.08"	W111°51'01.14"
10	4452	N041°48'43.70"	W111°51'04.87"

**LEGEND**

- PHASE 1 WORK AREA (SHEET 2 OF 4)
- PHASE 2 WORK AREA (SHEET 3 OF 4)
- PHASE 3 WORK AREA (SHEET 4 OF 4)
- CONTRACTOR STAGING AREA
- LOW PROFILE BARRIER
- CONTRACTOR HAUL ROUTE
- SHEET #
- ROFA = RUNWAY OBJECT FREE AREA
- ROFZ = RUNWAY OBSTACLE FREE ZONE
- RSA = RUNWAY SAFETY AREA
- TOFA = TAXIWAY OBJECT FREE AREA
- TSA = TAXIWAY SAFETY AREA

LATITUDE AND LONGITUDES (LAT/LONG) DELINEATION OF THE CONSTRUCTION AREA AND CONTRACTOR STAGING AREA LIMITS

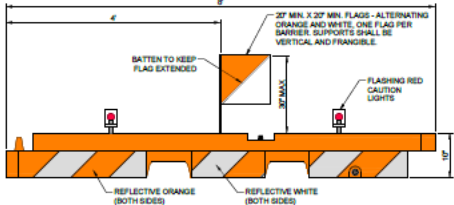

- NOTES**
- BARRIER SHALL BE SHERWIN INDUSTRIES, 10' x 96" LOW PROFILE AIRPORT BARRIER, AS SHOWN, OR APPROVED EQUAL.
  - THE ENTIRE AREA OF ORANGE AND WHITE STRIPES SHALL BE REFLECTORIZED WITH SMOOTH SURFACE TYPE REFLECTIVE SHEETING.
  - LIGHTS MUST BE MOUNTED ON BARRIERS AND SPACED AT NO MORE THAN 10 FT.
  - THE BARRIERS SHALL BE WEIGHTED AGAINST PROPWASH AND CAPABLE OF WITHSTANDING UP TO 100 M.P.H. WIND FORCES.
  - FLASHING RED CAUTION LIGHTS SHALL BE BATTERY OPERATED AND SHALL MAINTAIN SUCH INTENSITY SO AS TO BE READILY IDENTIFIED FROM DISTANCES OF AT LEAST 300 FEET DURING DARKNESS.
  - THE CONTRACTOR SHALL CHECK ALL BARRIERS AND LIGHTS EACH DAY BEFORE LEAVING THE AIRPORT TO ENSURE LIGHTS ARE WORKING PROPERLY AND MAY NOT LEAVE WITHOUT ALL BARRIERS AND LIGHTS BEING IN PROPER WORKING ORDER.

**1 LOW PROFILE SAFETY BARRIER**  
1 NOT TO SCALE

- NOTE:**
- SEE SHEET 2 OF 4 FOR PHASE 1 LOW PROFILE SAFETY BARRIER PLACEMENT.
  - SEE SHEET 3 OF 4 FOR PHASE 2 LOW PROFILE SAFETY BARRIER PLACEMENT.
  - SEE SHEET 4 OF 4 FOR PHASE 3 LOW PROFILE SAFETY BARRIER PLACEMENT.

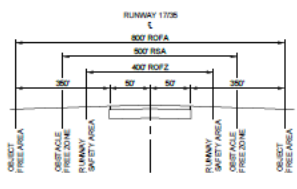
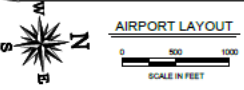

ALL STATIONARY CONSTRUCTION EQUIPMENT AND STOCKPILES MUST REMAIN CLEAR OF ANY OPEN RUNWAY OBJECT FREE AREA. ALL CONSTRUCTION EQUIPMENT AND TRAFFIC MUST REMAIN CLEAR OF ANY OPEN RUNWAY OBSTACLE FREE ZONE.

**2 SAFETY AREAS**  
1 NOT TO SCALE

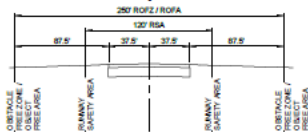

ALL CONSTRUCTION EQUIPMENT, STOCKPILES, AND TRAFFIC MUST REMAIN CLEAR OF ANY OPEN RUNWAY OBSTACLE FREE ZONE / OBJECT FREE AREA.

**3 SAFETY AREAS**  
1 NOT TO SCALE

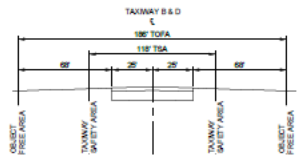

ALL CONSTRUCTION EQUIPMENT, STOCKPILES, AND TRAFFIC MUST REMAIN CLEAR OF ANY OPEN TAXIWAY OBJECT FREE AREA.

**4 SAFETY AREAS**  
1 NOT TO SCALE

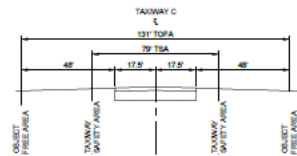

ALL CONSTRUCTION EQUIPMENT, STOCKPILES, AND TRAFFIC MUST REMAIN CLEAR OF ANY OPEN TAXIWAY OBJECT FREE AREA.

**5 SAFETY AREAS**  
1 NOT TO SCALE



LOGAN-CACHE AIRPORT  
LOGAN, UTAH  
RECONSTRUCT AIRFIELD  
GUIDANCE SIGNS  
AIP No. 3-49-0016-039-2023

NO.	REVISION	DATE	BY

ACI No. 23606  
Date: APRIL 2023  
File Name: 23606150

Drawn: MLM  
Checked: TTM  
Approved: DHT

**CONSTRUCTION  
SAFETY &  
PHASING  
PLAN**

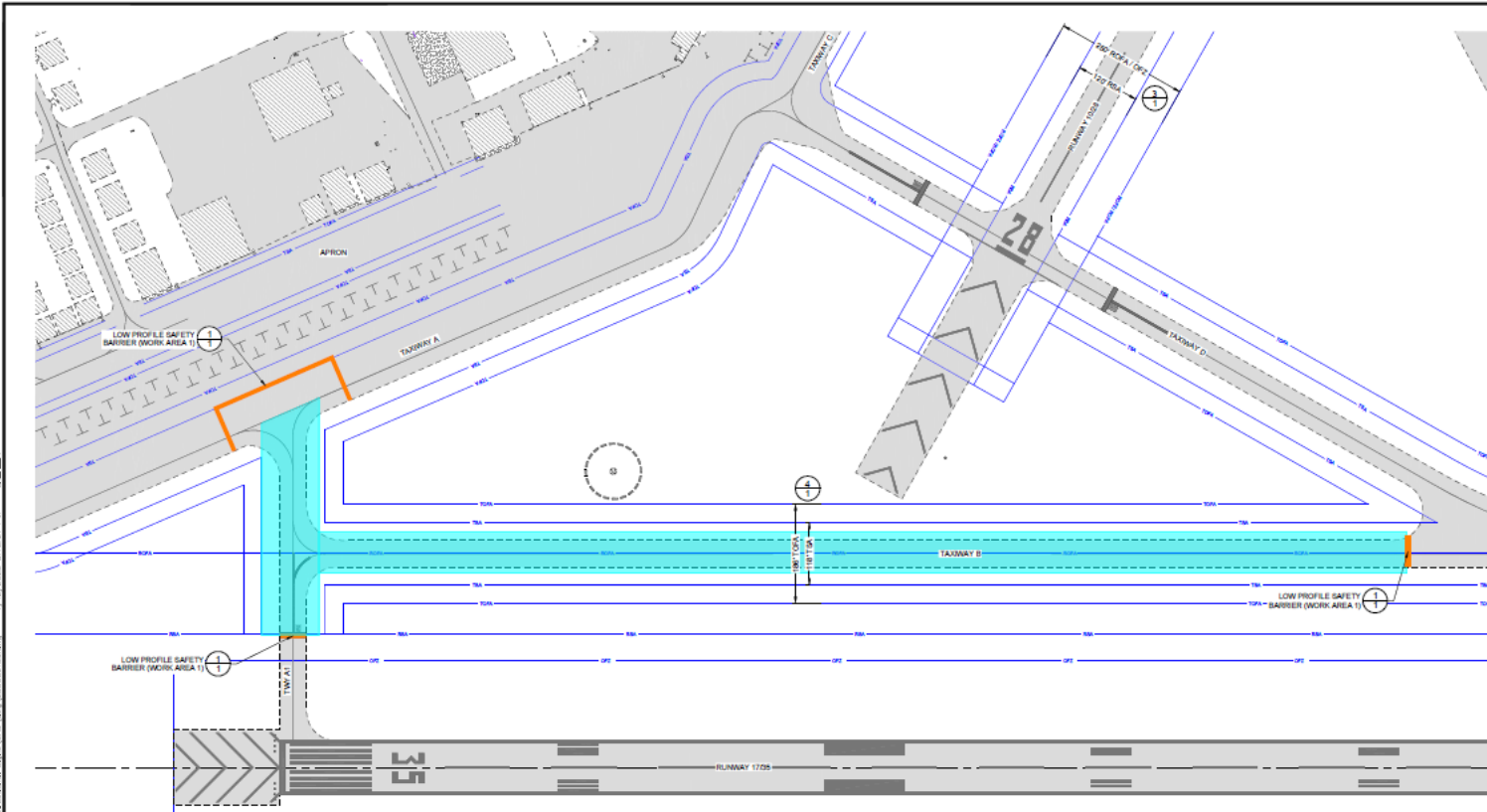

- LEGEND**
- PHASE 1 WORK AREA (SHEET 2 OF 4)
  - PHASE 2 WORK AREA (SHEET 3 OF 4)
  - PHASE 3 WORK AREA (SHEET 4 OF 4)
  - CONTRACTOR STAGING AREA
  - LOW PROFILE SAFETY BARRIER
  - CONTRACTOR HAUL ROUTE
  - DETAIL #
  - SHEET #
  - ROFA • RUNWAY OBJECT FREE AREA
  - ROFZ • RUNWAY OBSTACLE FREE ZONE
  - RSA • RUNWAY SAFETY AREA
  - TOFA • TAXIWAY OBJECT FREE AREA
  - TSA • TAXIWAY SAFETY AREA
- LATTITUDE AND LONGITUDE** (EASTING) DELINEATION OF THE CONSTRUCTION AREA AND CONTRACTOR STAGING AREA LIMITS

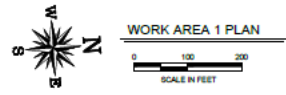

No.	Revised	Date	By

ACI No. 23506  
Date: APRIL 2023  
File Name: 23506/150

Drawn: MLM  
Checked: TTM  
Approved: DJH

**CONSTRUCTION  
SAFETY &  
PHASING  
PLAN**

- LEGEND**
- PHASE 1 WORK AREA (SHEET 2 OF 4)
  - PHASE 2 WORK AREA (SHEET 3 OF 4)
  - PHASE 3 WORK AREA (SHEET 4 OF 4)
  - CONTRACTOR STAGING AREA
  - LOW PROFILE BARRIER
  - CONTRACTOR HAUL ROUTE
  - DETAIL #
  - SHEET #
  - ROFA - RUNWAY OBJECT FREE AREA
  - ROFZ - RUNWAY OBSTACLE FREE ZONE
  - RSA - RUNWAY SAFETY AREA
  - TOFA - TAXIWAY OBJECT FREE AREA
  - TSA - TAXIWAY SAFETY AREA
- LATITUDE AND LONGITUDES (LATS/LONGS) DELINEATION OF THE CONSTRUCTION AREA AND CONTRACTOR STAGING AREA LIMITS**

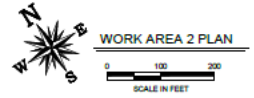
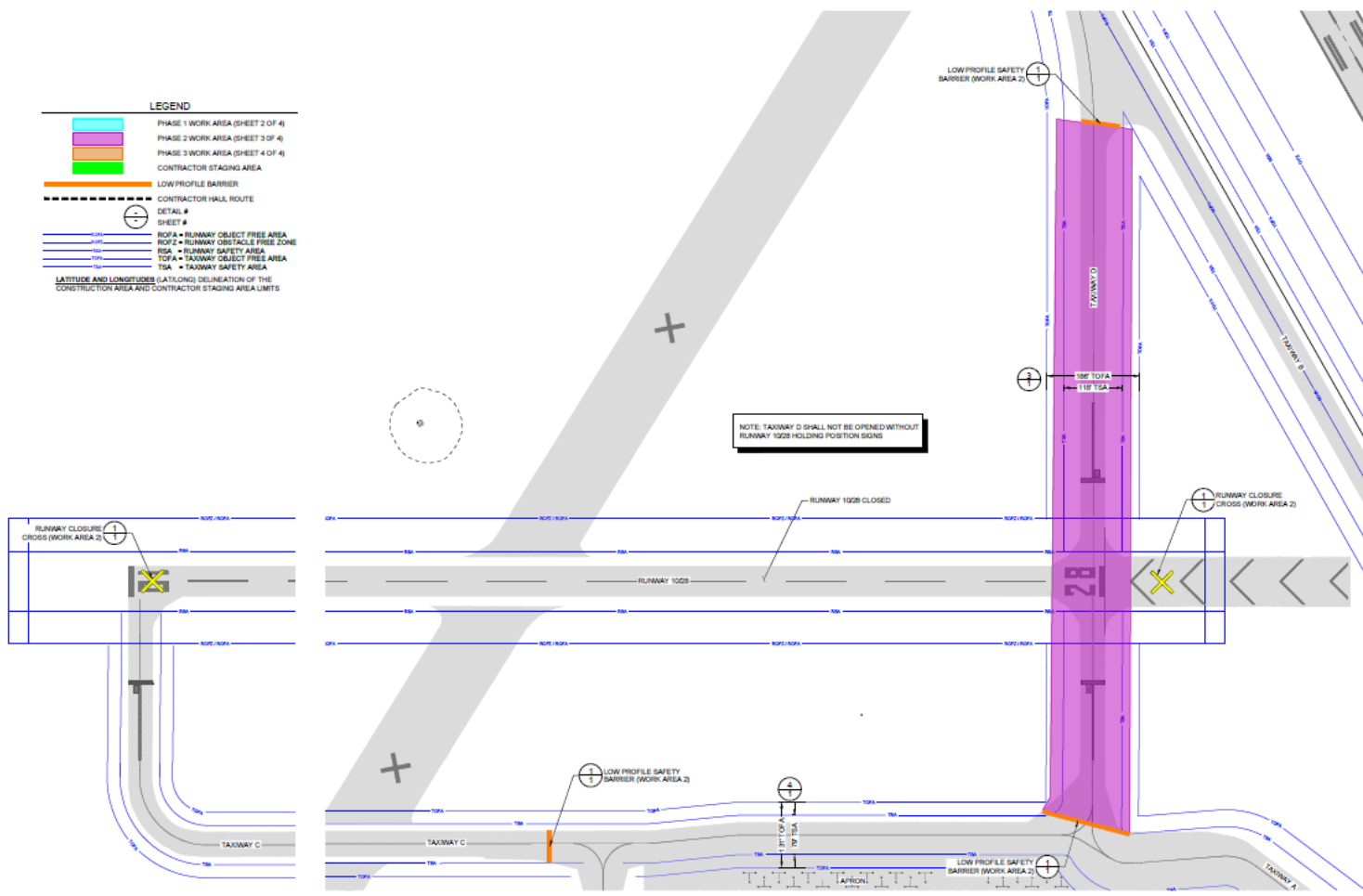

**WORK AREA 2 PLAN**

No.	Revisions	Date	By

ACI No. 23606  
Date: APRIL 2023  
File Name: 23606150

Drawn: MLM  
Checked: TTM  
Approved: DHT

**CONSTRUCTION  
SAFETY &  
PHASING  
PLAN**

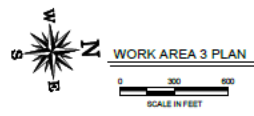
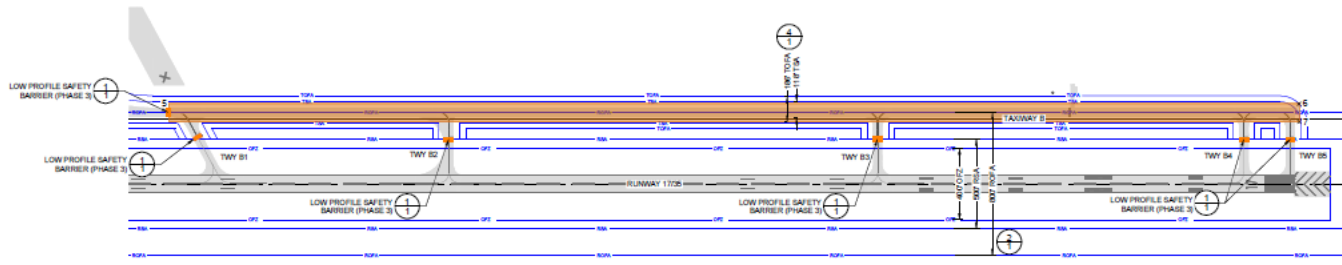

NOTE: LOW PROFILE SAFETY BARRIERS ARE LOCATED 200' FROM RUNWAY CENTERLINE AT THE BACK PORTION OF THE HOLD BARS.



RUNWAY CLOSURE MARKER, LIGHTED

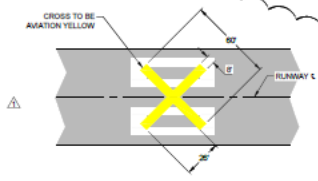

**NOTES:**  
 THE CONTRACTOR SHALL COORDINATE AND USE THE AIRPORT'S LIGHTED CLOSURE CROSSES. THE CONTRACTOR SHALL PLACE ONE MARKER OVER THE RUNWAY DESIGNATION NUMBERS EACH END FOR THE ENTIRE TIME THAT THE RUNWAY IS CLOSED. THE CONTRACTOR SHALL ENSURE THAT THE CROSSES ARE SECURELY ANCHORED SO THEY WILL NOT MOVE DURING HEAVY WIND.  
 THE CONTRACTOR SHALL PROVIDE ALL FUEL, OIL, LAMPS, AND ANY OTHER MAINTENANCE REQUIRED DURING THE PROJECT. ANY DAMAGE RESULTING FROM THE CONTRACTOR'S NEGLIGENCE SHALL BE IMMEDIATELY REPAIRED BY THE CONTRACTOR AT NO COST TO THE AIRPORT. THE LIGHTED CROSSES SHALL BE TRANSPORTED ON APPROVED AIRPORT SURFACES. THE CROSSES SHALL BE STORED AT THE LOCATION DESIGNATED BY THE AIRPORT. CONTRACTOR WILL BE RESPONSIBLE FOR MOVING THE PORTABLE TRAILER MOUNTED EQUIPMENT. ALL COST FOR USE, TRANSPORTATION, OPERATION, AND MAINTENANCE OF THE LIGHTED CLOSURE CROSSES SHALL BE INCIDENTAL TO THE PROJECT.  
 IF THE LIGHTED CLOSURE CROSS BECOMES INOPERABLE DURING THE PROJECT AT ANY TIME, CONVENTIONAL YELLOW CLOSURE MARKERS SHALL BE IMMEDIATELY INSTALLED IN PLACE OF THE LIGHTED CLOSURE CROSS UNTIL IT IS REPAIRED OR REPLACED BY THE CONTRACTOR. THE CONTRACTOR SHALL BE IN POSSESSION OF AT LEAST ONE SET OF CONVENTIONAL CLOSURE CROSSES AT ALL TIMES TO BE INSTALLED IMMEDIATELY IF ONE OF THE CROSSES BECOMES INOPERABLE.

1  
4 RUNWAY CLOSURE CROSS  
NOT TO SCALE

- LEGEND**
- PHASE 1 WORK AREA (SHEET 2 OF 4)
  - PHASE 2 WORK AREA (SHEET 3 OF 4)
  - PHASE 3 WORK AREA (SHEET 4 OF 4)
  - CONTRACTOR STAGING AREA
  - LOW PROFILE BARRIER
  - CONTRACTOR PAUL ROUTE
  - DETAIL #
  - SHEET #
  - RDFA = RUNWAY OBJECT FREE AREA
  - ROFZ = RUNWAY OBSTACLE FREE ZONE
  - RSA = RUNWAY SAFETY AREA
  - TOFA = TAXIWAY OBJECT FREE AREA
  - TSA = TAXIWAY SAFETY AREA
- LATITUDE AND LONGITUDES (E, L, AT, LONG) DELINEATION OF THE CONSTRUCTION AREA AND CONTRACTOR STAGING AREA LIMITS

NO.	DATE	BY	REVISION

ACI No. 235006  
Date: APRIL 2023  
File Name: 23500150

Drawn: MLM  
Checked: TFM  
Approved: DLI

CONSTRUCTION  
SAFETY &  
PHASING  
PLAN